

Recycling

The Long and Winding Road



Adam J. Bello
County Executive

PACNY Conference
February 27, 2020



SWANA[®]
SOLID WASTE ASSOCIATION
of North America

Agenda

- **History of Recycling**
- **Global Recycling Market Dynamics**
- **Wishcycling**
- **Recycling & Waste Reduction Tools**
- **Hot Topics**
- **Mythbusters**



Adam J. Bello
County Executive



History of Recycling

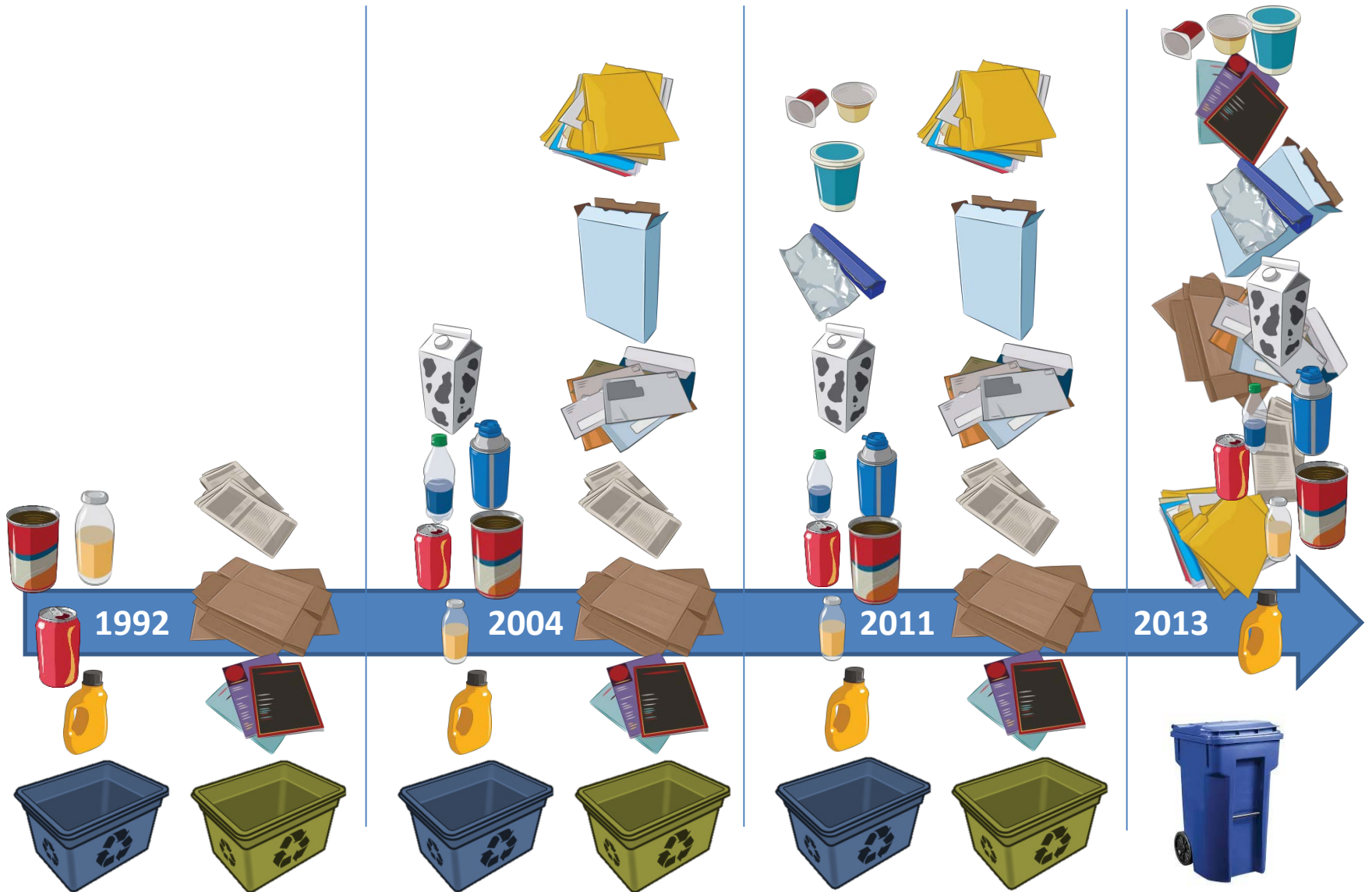

Global Recycling Market Dynamics

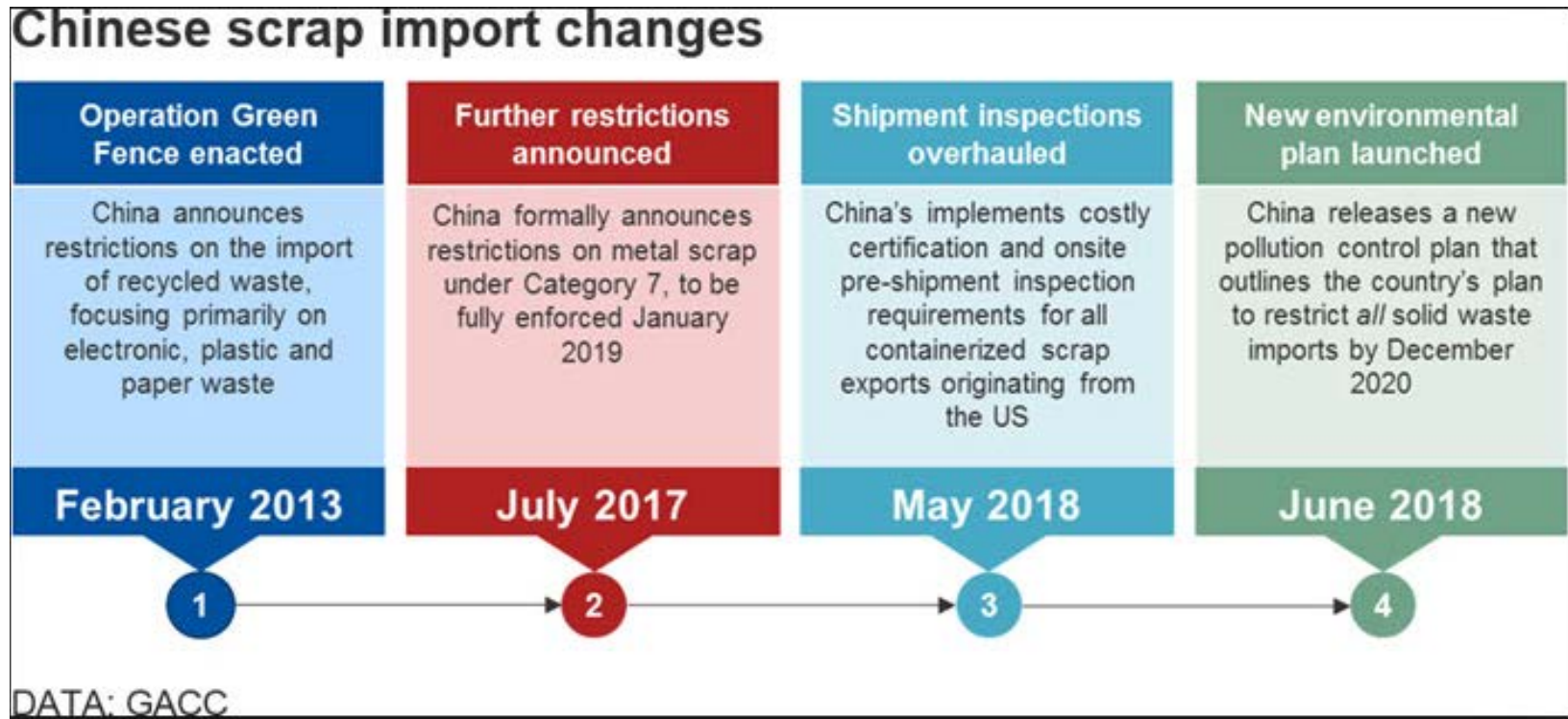

Adam J. Bello
County Executive



SWANA[®]
SOLID WASTE ASSOCIATION
of North America

CHINA WASTE IMPORT RESTRICTIONS: MATERIALS AFFECTED



POST-CONSUMER PLASTIC WASTE

- Soft drink bottles
- Water bottles
- Takeout containers
- Milk jugs
- Juice bottles
- Cleaning supplies
- Shampoo
- Grocery bags
- Cereal box liners
- Condiment containers
- Produce bags
- Bread bags
- Garbage bags
- Beverage cups
- Yogurt cups
- Margarine tubs
- Plastic film
- PET
- Polystyrene
- PVC



BANNED RECYCLABLES

Unsorted waste paper of various grades, such as:

- Old mail
- Paperboard packaging
- Magazines
- Copy and computer paper
- Egg cartons

LOWER CONTAMINATION RATES 0.5%

- Cardboard
- Sorted paper

For more information visit SWANA.org/ChinaResources



U.S. Exports to China of Scrap Plastics & Mixed Paper

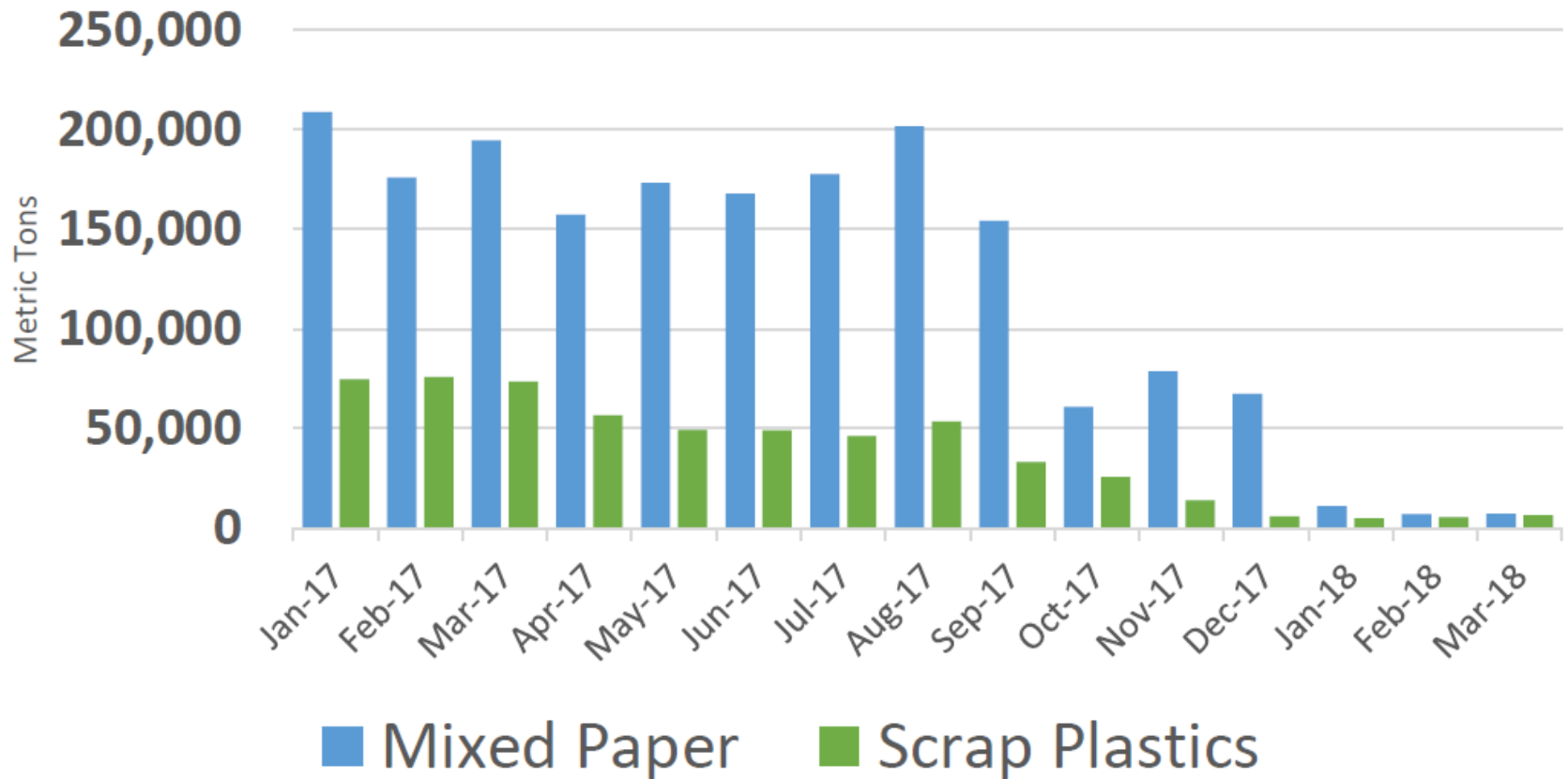

Data from U.S. Census Bureau/U.S. International Trade Commission courtesy of ISRI



Adam J. Bello
County Executive



SWANA[®]
SOLID WASTE ASSOCIATION
of North America

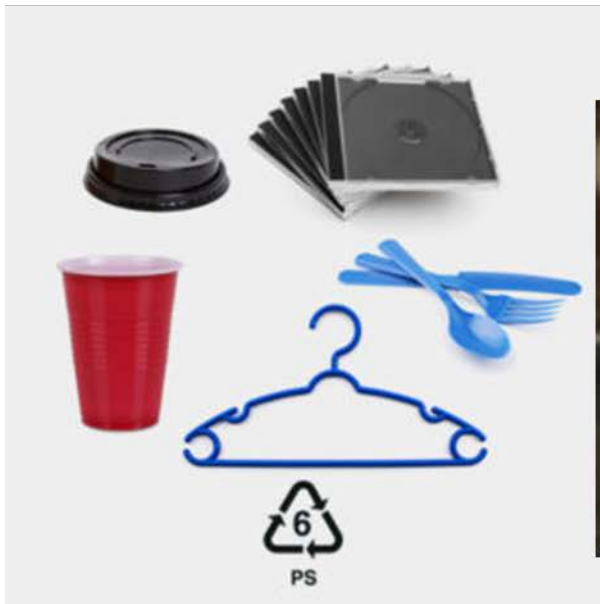

Adam J. Bello
County Executive



SWANA[®]
SOLID WASTE ASSOCIATION
of North America



What does this mean for recycling in New York?

- Need to:
 - Get back to basics of good recycling
 - Clarify types of recyclables accepted
 - Communicate consistently to residents among municipalities, facilities, and collection companies
 - *Choose Reduce & Reuse before Recycle*



Communication Tools

- www.monroecounty.gov/recycling
- www.ecoparkmcny.com
- Flyers & Magnets
- Recyclopedia
- FAQ
- E-Newsletters
- Facebook page
- Signs



Meet us at the Market

To assist in making the recycling market more vibrant and local, we have organized a series of "Meet Us at the Market" events. These events provide an opportunity for recycling centers to meet with local business owners and other community members to discuss recycling options and to provide information on recycling services.

"Recycling is a critical component of our efforts to protect the environment, create jobs and enhance our quality of life. Despite existing international trends that create challenges in recycling markets, we take our commitment to sustainability seriously and will continue to offer a robust recycling operation in all corners of our community. This summer, we'll host our Environmental Markets at Farmers Markets and other community events to learn more about the ways you can reduce, reuse and recycle to help protect our environment."

- Cheryl Smith, Monroe County Executive

In the News



Contaminations, the amount of non-recyclable items that end up in bins, has led China to implement import restrictions, disrupting the global recycling market. While the vast majority of recyclables processed at the www.monroecounty.gov are sent to domestic recycling markets, China's tightened standards have greatly impacted domestic markets as well. Many recycling centers have added more employees and invested in new equipment, increasing labor and equipment costs to meet new contamination standards, while commodity values have declined.



Adam J. Bello
County Executive



SWANA
SOLID WASTE ASSOCIATION
of North America

MIXED RECYCLING



✓ **EMPTY**

✓ **CLEAN**

✓ **UNBAGGED**

PAPER

- Empty cartons - **NO liquids or straws**
- Flatten boxes
- Contain shredded paper in paper bag or box

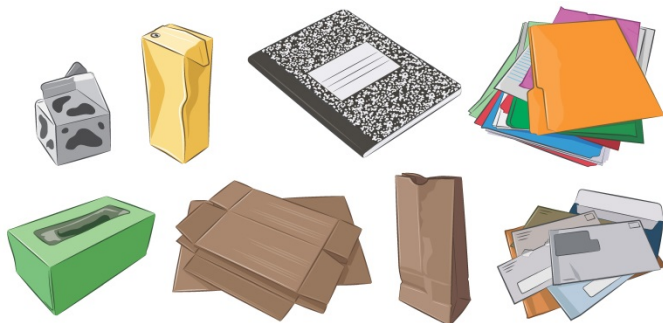

PLASTIC

- Empty bottles, jugs, jars and tubs - **NO food or liquids**
- Reattach lids and caps



METAL & GLASS

- Clean foil
- Empty cans and bottles - **NO liquids**
- Reattach lids and caps

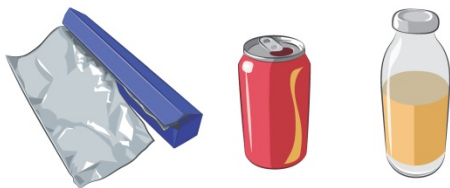

- **NO bags**
- **NO cups**
- **NO food**
- **NO liquids**



WHEN IN DOUBT, THROW IT OUT!

www.monroecounty.gov/recycling



TRASH



POUCHES AND WRAPPERS



DISPOSABLE FOOD ITEMS

- Napkins, tissues and paper towels
- Wet or dirty items
- Cups/lids



SINGLE-USE PLASTICS



FOAM



PLASTIC BAGS AND FILM



FOOD AND LIQUIDS



www.monroecounty.gov/recycling



Hot Topics

- Plastic Bag Ban
- Food Donation and Food Scraps Recycling
 - Food Waste Reduction
- NYS Drug Take Back Program
- Batteries
- Textiles
- Safety



Adam J. Bello
County Executive



Plastic Bag Ban

Date Ban Goes into Effect

- Single use plastic bags will be banned as of March 1, 2020.

Stores Impacted

- All stores that collect sales tax (retailers, grocery and any small business) will be required.

Plastic Bags Exempt

- Bags that are not included are:
 - Bags made of cloth and other durable materials with handles.
 - Bags used for uncooked meat, fish or poultry
 - Bulk items
 - Sliced or prepared food
 - Newspaper bags (delivered)
 - Prescription drugs



Paper Bags

- Paper bags are not part of the ban.



Adam J. Bello
County Executive



SWANA[®]
SOLID WASTE ASSOCIATION
of North America

Food Donation & Food Scrap Recycling Legislation

- 2 tons per week or more of food scraps.
- Supermarkets, large food service businesses, higher educational institutions, hotels, food processors, correctional facilities, and sports or entertainment venues.
- Exempt: residential sources, hospitals, nursing homes, adult care facilities, and elementary and secondary schools



Food Waste Reduction

Pollution Prevention Institute Tools

<https://www.rit.edu/affiliate/nysp2i/food/source-reduction>



Resources for Preventing and Recycling Food Waste at Home

According to the US Department of Agriculture, the US wastes roughly 40% of its food – the equivalent of about \$161 billion per year. Food waste is wasted at every point along the food chain: on farms and in fishing boats; during processing and distribution; in retail stores and restaurants; and at home. In fact, close to 43% of food waste overall comes from households. This means preventing and recycling food waste at home has the potential to significantly reduce food waste overall in the US.

There are countless resources available online to help guide people through understanding how to tackle food waste at home. NYSPP2I has sorted through these resources online and summarized our favorites here.

FACTS AND STATS

New to the issue of food waste? Understand the problem with these materials.

1. Browse the NYSPP2I Clearinghouse to learn about food waste and for business-focused tools.
2. Scroll through Food is for Eating for an introduction to the issue of food waste.
3. See Food for Thought for some overview stats about food waste that you need to know.
4. Get some key stats and beginning tips to stopping food waste at Save the Food.
5. Learn how food waste is tied closely with food insecurity with Feeding America.
6. Want a deep dive? ReFED rethinks food waste through economics and data.

PREVENTION

Learn to rethink your at-home food habits to stop wasting food.

1. Do Good Save Food shares nine easy tips to preventing food waste at home.
2. Talk trash to learn to save money with USDA's Choose My Plate.
3. Stop Waste is a Pinterest-like list of fun and easy ideas to creatively use extra food.
4. Become educated on prevention strategies with EPA's Reducing Wasted Food at Home.
5. Learn how to properly store food for maximum shelf life by using A-Z Food Storage Tips and Food Storage Tips - Quick Reference.
6. Plan your meals and shopping lists to save money with this Meal Planner.

DIVERSION

Want to stop throwing food scraps in the trash? There are lots of better options!

Composting – whether it is done at home or off site, composting is a great way to give food scraps a second life while creating healthy soil.

1. Compost Made Easy walks through the basics of composting: what, why, and how.
2. What to Compost tells you what items to compost as well as a troubleshooting guide.
3. How to Use Compost get you the most benefit from composting by understanding how to use it.
4. Use the Outdoor Composting Guide to learn to setup, monitor and benefit from your own bin.
5. Take tips from some of the pros with Tomkins County - Cornell Cooperative Extension.
6. Worms?! Yes, worms. Indoor Composting with a Worm Bin and Worm Bin Troubleshooting.
7. Everything you could want to know about composting is in the NYC Master Composter Manual.
8. Curious about what diversion facilities are near you? Check out the NYSPP2I Organic Resource Locator, or the Cornell Waste Management Institute's Compost Facilities Map.

Donation- have extra dry goods or surplus from your garden? Get it to hungry people through one of your local food banks or food pantries.

1. Learn about the realities of hunger in your community through Feeding
2. Looking for a food pantry? Search Find a Food Pantry, Food Pantries
3. For the ins-and-outs of donating food, take a look at the EPA's Donati

Viewing this as a print-out? Find the e-version here to follow the resource links <http://bit.ly/food>



Adam J. Bello
County Executive



SWANA[®]
SOLID WASTE ASSOCIATION
of North America

NYS Drug Take Back Program

- Drug Take Back. Pursuant to Chapter 120 Laws of 2018, the New York State Drug Take Back Act (DTB) mandates that manufacturers establish, fund, and manage a New York State approved drug take back program(s) for the safe collection and disposal of unused covered drugs



Adam J. Bello
County Executive



Batteries

- Common single-use alkaline or zinc batteries are generally **NOT accepted** for recycling and can be disposed in the trash BUT should check with your local municipality.
- It is illegal to dispose of rechargeable, button and sealed lead batteries in the trash.
 - Manufacturers are required by law to provide free collection and recycling.
 - Retailers such as Best Buy, Lowes, Staples, Sprint, Target, Verizon Wireless, Batteries Plus Blubs, and other mail back programs will accept certain types of rechargeable and button batteries for recycling.

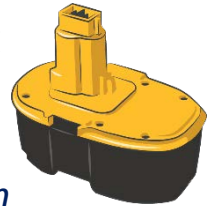
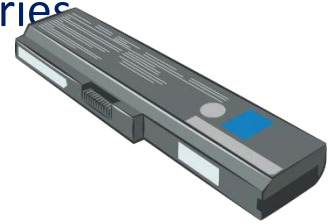
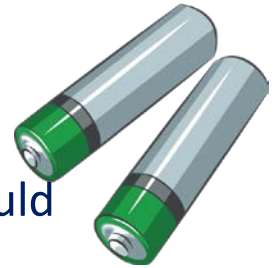

To prevent the risk of fire, use clear tape to cover the terminals before dropping them off at the ecopark. Visit the ecopark website to find a convenient location to drop off your recyclable batteries. Check each site's list of accepted items to make sure your battery is accepted. Disposable alkaline and car batteries are generally not accepted.



Adam J. Bello
County Executive



SWANA[®]
SOLID WASTE ASSOCIATION
of North America

Textiles

- ReClotheNY
 - <https://www.nysar3.org/page/re-clothe-ny-78.html>
- Donations
 - Many options are available for donating textiles, furniture, building materials, eyeglasses, etc.
 - In addition to clothes, most major thrift stores and donation centers will accept footwear, bedding, curtains, stuffed animals, and other items.
 - Clothes that are no longer wearable can still be donated. **Any torn, worn, or stained items can be recycled at major donation centers as long as they are clean, dry, and odorless.**



TEXTILE RECOVERY
#ReClotheNY



Adam J. Bello
County Executive



The Life Cycle of Secondhand Clothing

What happens to your donated or recycled used clothing?

On average, each American donates or recycles 12 pounds of apparel, footwear, and household textiles.¹ Here's what happens next...



Did you know?

Worn or torn, all dry clothing, shoes, and textiles can be donated or recycled.

Thrift Industry employs nearly 100,000 workers in the U.S. with over \$1 billion in wages paid. In addition, private sector recyclers create an additional 15,000 to 20,000 jobs nationally.²

Most private sector recyclers are small businesses with fewer than 500 employees. Every 1,000 lbs donated and recycled generates two man days of labor. Primary and secondary recyclers account for annual gross sales in excess of \$700 million.³

Charities and private sector combined handle 3.8 billion pounds annually.⁴ These tremendous volumes are recycled and processed due to a highly efficient industry. Your secondhand clothing goes through this entire process in just 30-60 days.⁵



The textile recycling process follows the conventional recycling maxim of **Reduce, Reuse, Recycle!**

SOURCES ¹ EPA 2009 FEDERAL MSW waste study; 3.8 billion lbs recovered divided by 2010 US Census Population 310 million.
² "Textile Recycling in the U.S." Report submitted to SMART by Dr. Jana Hawley Ph.D. Univ. of Missouri. 2009
³ Ibid.
⁴ EPA 2009 Federal MSW waste study.
⁵ CTR estimate.

Chart 4. Fatal work injury rates per 100,000 full-time equivalent workers by selected occupations, 2018

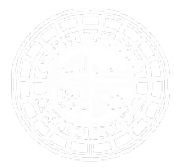



A Campaign to Save Lives



- Federal Government's List of 10 Most Dangerous Jobs
- At least 59 solid waste industry workers died on the job in 2018 in the United States and Canada, according to the Solid Waste Association of North America ([SWANA](#)), an increase of 19 fatalities from the previous year.

2018 WORKER FATALITIES BY LOCATION

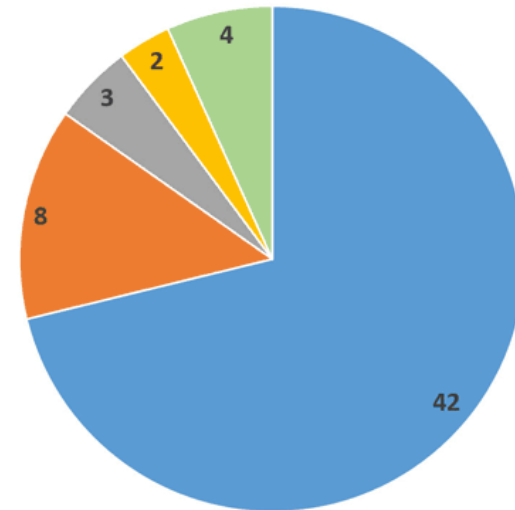

■ Collection ■ Landfill ■ MRF ■ Transfer Station ■ Other



Mythbusters: Can it be recycled curbside?

True or False?



Adam J. Bello
County Executive



Your Neighbor Always Knows What is Recyclable...So Just Ask Them

FALSE



- Always check with your local municipality or hauler. They know what is and is not acceptable.
- Sign up for DEC Delivers e-newsletters and share our “Can I Recycle That?” editions with the public
<https://www.dec.ny.gov/public/65855.html>
- Recycling Coordinator Contacts (newly updated):
<https://dec.ny.gov/chemical/8511.html>



Adam J. Bello
County Executive



Plastic utensils & straws can be recycled.

FALSE

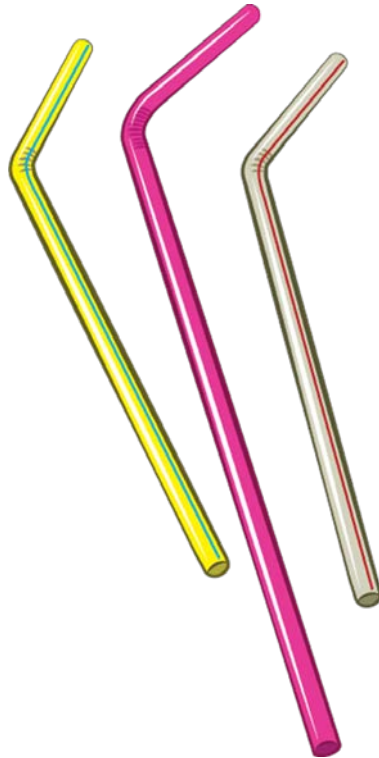

Plastic straws, utensils, including “compostable” utensils, plastic plates and plastic cups come in such a wide variety of nonusable, low-grade plastics that it is impossible to identify and separate the recyclables from the non-recyclable look-alikes. Fast food packaging, like utensils, are complicated and are not readily recovered through modern Material Recovery Facilities (MRFs), or by secondary processors who buy MRF bales.



Adam J. Bello
County Executive



Plastic bags or film can be recycled curbside.

FALSE



- Neither Plastic bags nor plastic film are accepted curbside (they get tangled in the MRF equipment, breaking or stopping machinery.)
- Empty plastic bags and plastic film should go back to a participating retail outlet or grocery store for recycling.



Adam J. Bello
County Executive



The recycling arrows on a container means it is recyclable at a Material Recovery Facility (MRF)

Only in some cases

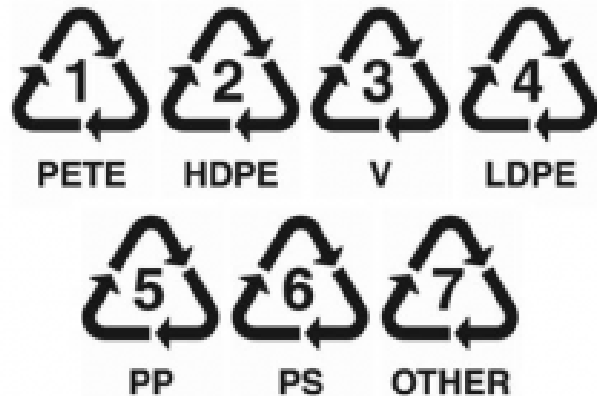

- The plastic resin identification codes #1-7 identify the plastic resin out of which the product is made.
- There are thousands of plastic products and packaging, and each one has its own unique chemical recipe. Many plastics cannot be made into new products at this time.



Adam J. Bello
County Executive



What Plastic Containers are accepted curbside?

Bottles, Jugs, Jars, Tubs



Chip bags, nutritional bar or candy wrappers can be recycled.

FALSE

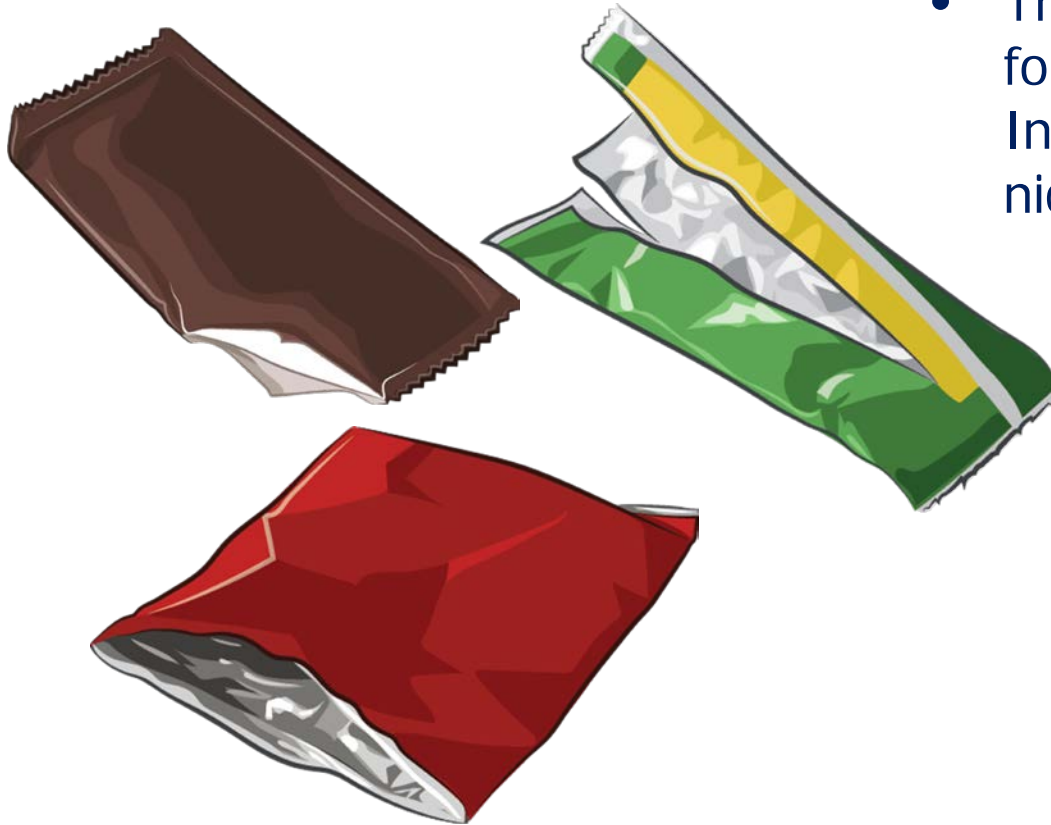

- There is no real end market for this, often hybrid material. In fact, there are only a few niche markets for it.



Adam J. Bello
County Executive



Pizza boxes can be recycled.

TRUE



- Clean pizza boxes (without food or paper liners/doilies) are acceptable. At one point, pizza boxes were made with a wax coating that made them not acceptable. The new pizza boxes (often with a paper doily serving as a moisture barrier) are high potential recyclables and should be included in curbside recycling.



Adam J. Bello
County Executive



Single serve cups can be recycled.

FALSE

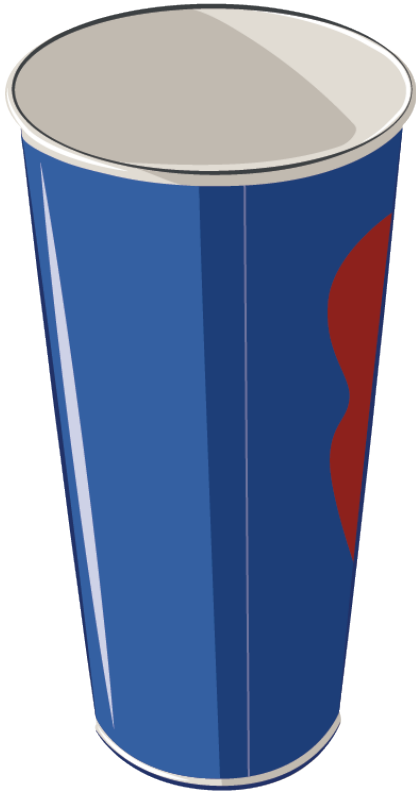

- Hot and cold paper cups have a plastic or waxed coating that does not break down during the re-pulping process at paper mills.
- Lids are also NOT recyclable.



Napkins, paper towels, and tissues can be recycled.

FALSE



- Napkins, paper towels and tissues are made of low-grade fiber, and are usually soiled when disposed. They are not recyclable in single stream residential Material Recovery Facilities (MRFs).
- The cardboard tube in the middle of the roll of paper towels or toilet tissue can be recycled.



Adam J. Bello
County Executive



Foam cups and containers can be recycled.

FALSE



- Polystyrene foam and plastic "to-go" containers and cups are made of unrecyclable materials, and cannot be collected curbside.
- Packing peanuts aren't recyclable either, however some shipping stores will take peanuts back for re-use.



Adam J. Bello
County Executive



Every week, Waste Management collects 100 bowling balls in its recycling facilities

TRUE



Nope.

Don't recycle bowling balls.

- That's more than 5,000 bowling balls a year and it works out to be 80,000 pounds of bowling balls annually.
- Everyday 14 people across the US put a bowling ball into their recycle bin



Adam J. Bello
County Executive





Adam J. Bello
County Executive

HHW accepted (w/ appointment):

- Automotive Fluids (antifreeze, brake, power steering and transmission fluids)
- Cleaners (soaps, waxes, drain cleaners, etc.)
- Driveway Sealers
- Flammables (gasoline, thinners, solvents, etc.)
- Mercury (thermometers, thermostats)
- Paint: Oil-based & Latex (more than 1/3 can full)
- Pesticides/Insecticides & Fertilizers
- Resins & Adhesives
- Wood Stain & Preservatives

Fee-Based Items

- Passenger Vehicle Tires
- TV/Computer Monitors (CRT, Flat Screen)
- Appliances with refrigerant

Giveback

- Free leaf compost

Accepted for free

- Appliances
- Bulky Plastic Items
- Clean White Styrofoam Packing (no labels or tape)
- Clothing & Accessories (Donation)
- Cooking Oil
- Document Destruction (items are destroyed off site)
- Electronic Waste
- Flags (U.S.)
- Fluorescent Lights
- Paper & Cardboard
- Pharmaceuticals & Rx Bottles
- Plastic Grocery Bags
- Printer Cartridges
- Propane Tanks (1# and 20#)
- Rechargeable and Button Batteries NO Alkaline Batteries
- Recyclable Glass/Metal/Plastic Containers
- Sharps & Syringes
- Scrap Metal (including bare tire rims)

Thank you!

Luann Meyer

SWANA-NY – Chapter President

Monroe County - Solid Waste Administrator

LuannMeyer@monroecounty.gov

(585)753-7608

www.monroecounty.gov/recycling

<https://swananys.org/>



Adam J. Bello
County Executive

